

CODE: **AWO452** v1.5/II  
 NAME: **EXPANDER 1**

EN

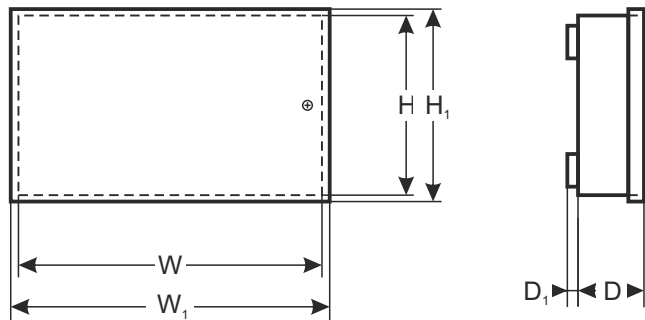

## DESTINATION

### DSC:

- 1) 2x ( 4108, 5108, 6108, 5208, 5100, 4116)
- 2) 1x ( 4216, 4580, 5400, 5580)

### SATEL:

- 1) 2x ( CA10E, CA64E, SM, MST1)
- 2) 1x CA64 ( PP, EPS, O-OC, O-ROC, O-R, OPS-OC, OPS- ROC, OPS-R, VGM-16, SR, ADR, ACC-KP- PS, PTSA)

### PARADOX:

- 1) 2x ( ZX4, ZX8, HUB2, ADM2, PGM4)

### RISCO:

- 1) 1x ( EZ8, EZ16, E04, E08)

## DANE TECHNICZNE

<b>External dimensions of the enclosure:</b>	W=218, H=150, D+D <sub>1</sub> =50+8 [± 2mm]
<b>External dimensions of the front panel:</b>	W <sub>1</sub> =222, H <sub>1</sub> =155 [± 2mm]
<b>Weight net/gross:</b>	0,70 / 0,75 [kg]
<b>Operating environment:</b>	class II, -10°C÷ 40°C
<b>Material description:</b>	sheet steel DC01, thickness: 0,7mm, protection anticorrosion, color: RAL 9003
<b>Destination:</b>	indoor
<b>Tamper protection:</b>	1 x microswitch: opening, 0,5 A@50 V DC max. NC - normally closed contacts
<b>Zamykanie:</b>	sheet-metal screws x 1
<b>Uwagi:</b>	distance from wall (mounting surface) - 8mm
<b>Deklaracje, gwarancja:</b>	CE, 2 lata od daty produkcji